

# PBI LABORATORY GAZETTE

MAY 2008

PBI TECHNICAL BULLETIN

VOL. 15 ISSUE 178

## MICROBIOLOGICAL DECONTAMINATION OF ENVIRONMENTS

### "GERMREDUC" FAMILY



#### WORKING PRINCIPLE:

"Germreduc" works with forced ventilation. Air is aspirated from the room through a special filter to remove large particles, flow around the U.V. lamps and then is expelled back into the room.



## EXAMPLE OF GERMREDUC INSTALLATION

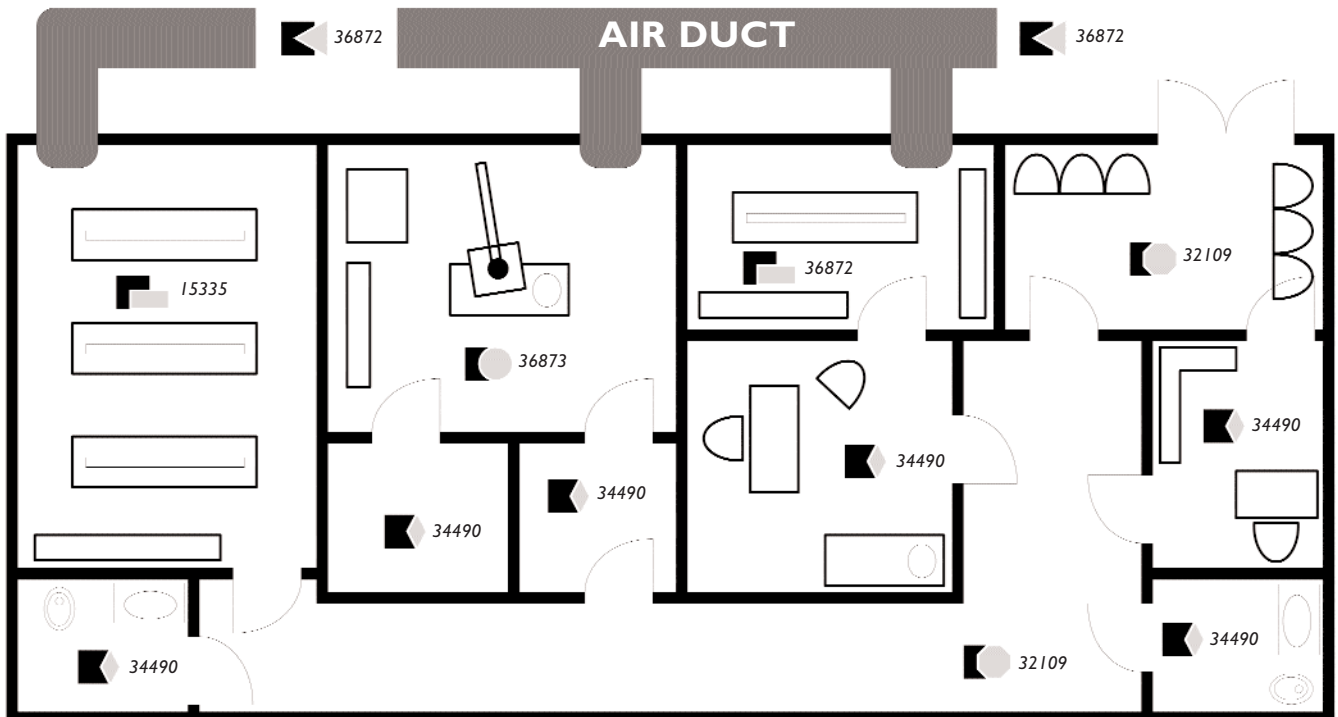

**UV HIVAC Germreduc (cat. n. 36872)**

is the new unit to be installed inside the ducts of the air conditioning plant. In fact the contamination of HIVAC ducts is the main responsible of the bad quality of indoor air from a microbiological point of view. The humidity on the inside surface of ducts, the dirty filters of the HIVAC system, the inadequate maintenance of the plant determine the micro-organisms growing and the consequent diffusion of germs in the indoor environment. Building Related Diseases (BRD) are the consequences.

The number of units to be installed inside the air ducts is related to air flow, volume, size, speed, etc.

Hospitals, Clinics, Pharmaceutical, food, public offices, microbiological laboratories premises are interested in UV HIVAC Germreduc.

**SUGGESTED NUMBER OF "GERMREDUC" UNITS TO BE INSTALLED**

**Germreduc - wall unit - cat. n. 32109** (E13127), 17435, 17488, 29186 (128 or 100 m<sup>3</sup> air per hour)

ROOM VOLUME (Cubic metre)	HIGH RISK ENVIRONMENT	LOW RISK ENVIRONMENT
150	1	1
300	2	1
500	3	2
750	4	2
1000	6	3

**Germreduc - floor unit - cat. n. 15335** (2x128 m<sup>3</sup> air per hour)

ROOM VOLUME (Cubic metre)	HIGH RISK ENVIRONMENT	LOW RISK ENVIRONMENT
150	1	1
300	1	1
500	2	1
750	2	1
1000	3	2

**Germreduc - ceiling unit - cat. n. 15336** (3x128 m<sup>3</sup> air per hour)

ROOM VOLUME (Cubic metre)	HIGH RISK ENVIRONMENT	LOW RISK ENVIRONMENT
150	1	1
300	1	1
500	2	1
750	2	2
1000	3	2

**Germreduc - wall - "Mini" cat. n. 34490** (43 m<sup>3</sup> air per hour)

LOW RISK SMALL ENVIRONMENT	150 Cubic metre
----------------------------	-----------------

**Super Germreduc - wall unit - cat. n. 36873** (400 m<sup>3</sup> air per hour)

ROOM VOLUME (Cubic metre)	HIGH RISK ENVIRONMENT	LOW RISK ENVIRONMENT
150	1	1
300	1	1
500	2	1
750	2	2
1000	3	2

**PERFORMANCES:**

"Germreduc" destroys the micro-organisms in the air by exposure to UV radiations.

Special features eliminate the UV exposure problems so that it is possible to carry out continuous and constant air sanitizing of any area during working hours without prejudice to the health of the personnel. "Super Germreduc" with ionizer is effective also to reduce bad smells and to improve the air quality. "U.V. Hivac Germreduc" is applied to the ventilation ducts of the HIVAC systems.

**DIFFERENT MODELS FOR DIFFERENT NEEDS**

"Germreduc" wall mounted - cat. n. 32109 - This model is suitable to be installed on walls. The air flow rate is 128 cubic meter per hour

"Germreduc" self standing mobile - cat. n. 15335 - The two vertical modules are fixed on a trolley and can be oriented separately in different directions. The air flow rate is 256 cubic meters per hour

"Super" - cat. n. 36873 - This model is suitable to be installed on walls and is active for the destruction of Mycobacterium tuberculosis. The air flow rate is 400 cubic meters per hour

"Portable Mini Germreduc" - cat. n. 34490 - This model allows to improve the hygienic conditions of the air in small rooms.

"U.V. Hivac" - cat. n. 36872 - This model is applied to the duct of the ventilation system.